

# USG™ Drywall Suspension System – 6 ft Cross Tees

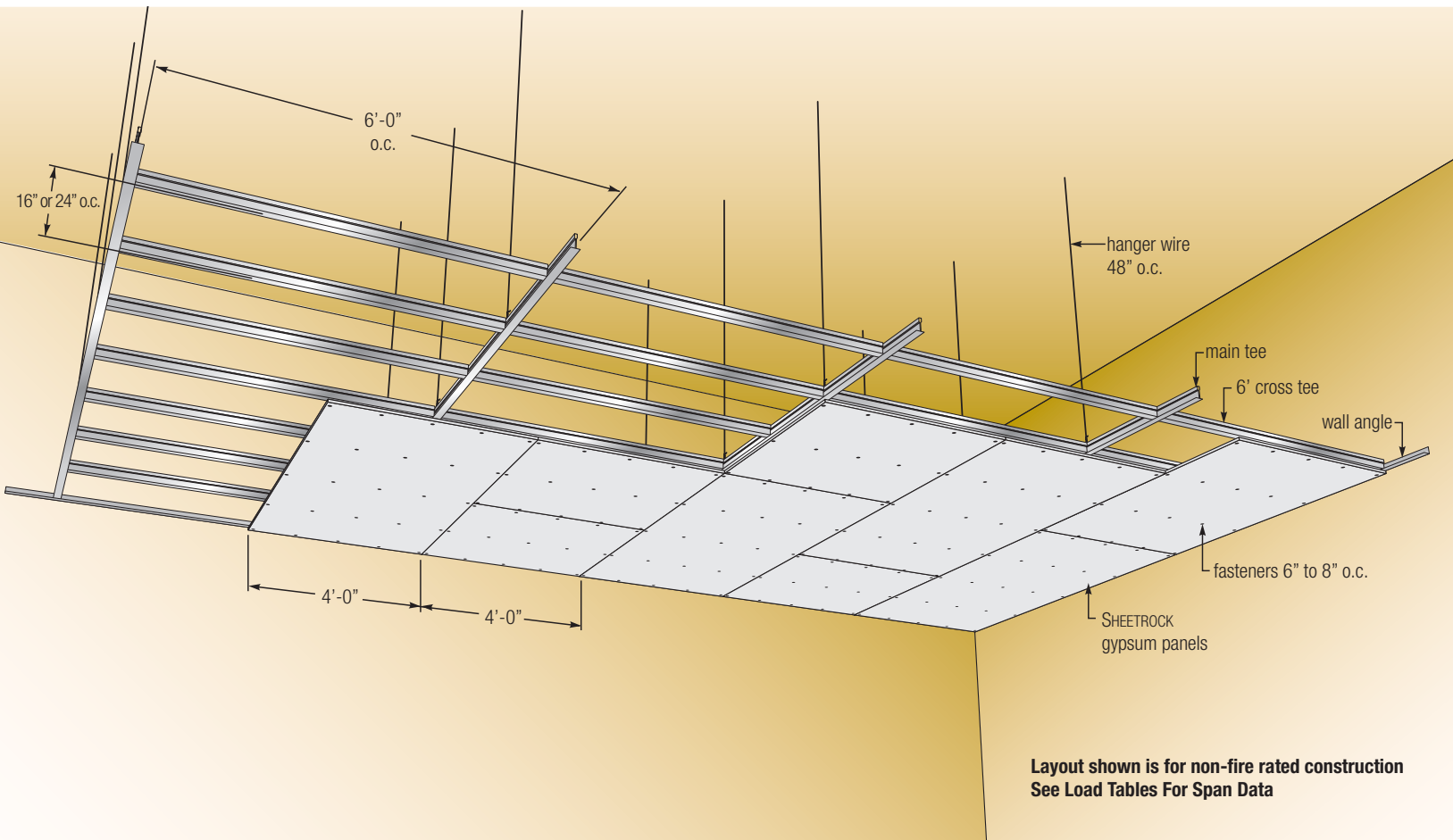

**Layout shown is for non-fire rated construction  
See Load Tables For Span Data**

USG Drywall Suspension System/  
SHEETROCK Gypsum Panels

#### Features and Benefits

- 6' OC main tee spacing means reduced material costs and up to 30% fewer hanger wires for faster installation.
- Supports a single layer of 5/8" SHEETROCK Firecode C Core with hanger wires at 48" OC. (Heavier ceiling loads are possible, see load table below.)
- Knurled surface reduces screw sidespin.
- Cross tee punchings easily accommodate type F light fixtures.
- Meets or exceeds ASTM C645.
- UL listed in 36 fire rated designs, many with light fixtures and duct openings.
- Fire rated designs up to 2-1/2 hours with one layer of Sheetrock Firecode C panels.

#### Applications

- Fire rated and non-fire rated ceilings
- Reduces field cutting in rooms that are multiples of 3' wide. (widths of 12', 15', 18', etc)
- Corridors
- Offices
- Hospitals
- Schools
- Hospitality

See LEED report tool at [usgdesignstudio.com](http://usgdesignstudio.com)  
for detailed sustainability information.

Profiles

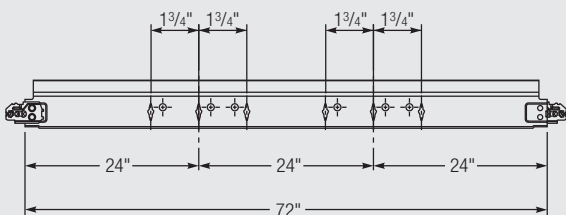

**To order samples, go to [usg.com](http://usg.com)**

DGLW624 cross tees for 6' OC main tee layout. Compatible with all other USG Drywall Suspension System Components.

# USG™ Drywall Suspension System – 6 ft Cross Tees

To order samples/literature:  
 Web: [usg.com](http://usg.com)  
 E-mail: [samplit@usg.com](mailto:samplit@usg.com)  
 Fax: 888.874.2348  
 Technical Services:  
 800.USG.4YOU (800.874.4968)

Websites:  
[usg.com](http://usg.com)  
[usgdesignstudio.com](http://usgdesignstudio.com)  
 For the most up-to-date  
 technical information:  
[usgdesignstudio.com](http://usgdesignstudio.com)



System meets or exceeds load compliance specifications per ASTM C635

System Components

Cross Tees

DGLW

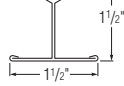
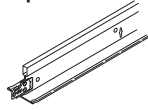

Length	Height	Item No.	Class	Recycled Content	Simple Span Load Data, L/360 (lbs/LF) <sup>2</sup>	
					Span	Value
72"	1-1/2"	DGLW624	Class A	up to 45%	72"	4.46

FIRECODE®

### Ceiling load values, hanger wires 48" OC, L/240

Cross Tee Spacing	24"	16"
Max ceiling weight, lbs-sf	3.4	5.1

### UL Fire Rated Designs up to 2-1/2 hours

Construction Group	UL Design Number
Concrete and Steel Floor Joists	D501, D502, D503, D505
Concrete and Steel Joists	G523, G524, G525, G526, G527, G528, G529, G531, G541, G555, G590
Wood Joists or Combination Wood and Steel Assemblies	L502, L508, L513, L515, L521, L525, L526, L529
Roof - Ceilings	P506, P507, P508, P510, P513, P514, P521, P522, P523, P525, P526, P527, P531

See [http://database.ul.com/cgi-bin/XYV/template/LISEXT/1FRAME/bxuv\\_search.html](http://database.ul.com/cgi-bin/XYV/template/LISEXT/1FRAME/bxuv_search.html) for construction details

For fire rated construction, all butt joints must be back blocked with a strip of 5/8" Sheetrock Firecode C

### Butt Joint Plain View

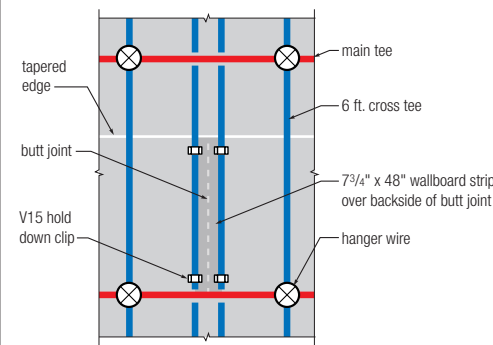

### Type F Light Fixture Layout

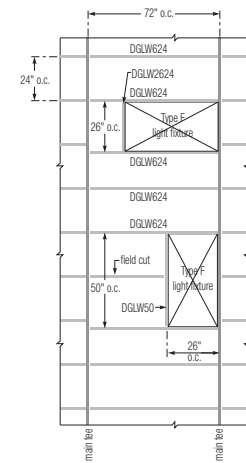

### Butt Joint Detail

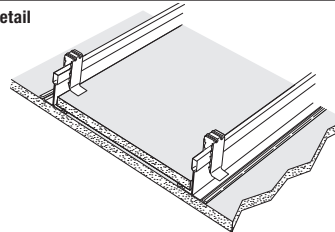

### PZ Variable Hold Down Clips

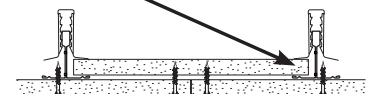

5/8" Sheetrock Firecode C      Type G Laminating Screws

### Physical Data/ Footnotes

**Product literature**  
 System brochure: AC3152  
 Data sheet: AC3117  
 Data sheet wall-to-wall: AC3230  
 Samples: 257/202

**Finishes**  
 Hot-dipped and galvanized.

**Material**  
 G40 double-web tee, hot-dipped galvanized steel.

**Recycled content**  
 For details, see the LEED report tool at [usgdesignstudio.com](http://usgdesignstudio.com).

**Installation**  
 Installation: Must be installed in compliance with ASTM C636, ASTM E580, GSCA and standard industry practices, within all applicable code requirements. Alternative assemblies and installation methods may be utilized when approved by the Authority Having Jurisdiction. USG recommends checking with the Authority Having Jurisdiction prior to designing and installing a suspended ceiling system.

**Limitations**  
 For exterior applications, the suspension system should be reviewed by a structural engineer. Please refer to SC2561 for more information about exterior ceiling applications.

**Code compliance**  
 The information presented is correct to the best of our knowledge at the date of issuance. Because codes continue to evolve, check with a local official prior to designing and installing a ceiling system. Other restrictions and exemptions may apply.

**Notes**  
 1. Load data shown based on L/240 deflection limits per ASTM C645.  
 2. Products tested and in compliance with ASTM C635 L/360 deflection limits.  
 3. For detailing and module loading, request AC3152 or visit [usgdesignstudio.com](http://usgdesignstudio.com).  
 4. DGLW26 main tees and DGLW2624 and DGLW50 cross tees feature special punching and cross-tee lengths to accommodate Type F fixtures.  
 5. G30 galvanization for severe environmental conditions.  
 6. DGW and DGLW members conform to performance standard ASTM C645.  
 7. Installation per ASTM C636.

**Notice**  
 We shall not be liable for incidental and consequential damages, directly or indirectly sustained, nor for any loss caused by application of these goods not in accordance with current printed instructions or for other than the intended use. Our liability is expressly limited to replacement of defective goods. Any claim shall be deemed waived unless made in writing to us within thirty (30) days from date it was or reasonably should have been discovered.



Manufactured by USG Interiors, LLC  
 550 West Adams Street  
 Chicago, IL 60661

The following are trademarks of USG Interiors, LLC or a related company: COMPASSO, FIRECODE, SHEETROCK, USG.

Safety First! Follow good safety/industrial hygiene practices during installation. Wear appropriate personal protective equipment. Read MSDS and literature before specification and installation.

AC3314/rev. 10-14  
 © 2014 USG Interiors, LLC  
 Printed in U.S.A.