

VSE

# Electric "Fresh Air" Deck-Mounted Skylight

The VELUX Electric "Fresh Air" Deck-Mounted Skylight is an ideal daylighting solution that brings in abundant natural light and, with the touch of a button, opens to let in fresh air. Mounting directly to your roof, it also comes equipped with a rain sensor to automatically close the skylight in the event of inclement weather.

**Ideal Applications:**  
Out of reach [kitchens](#) and [bathrooms](#) for optimal natural ventilation.

Eligible for a  
**Federal Solar Tax Credit**

off product and installation



## FEATURES & BENEFITS

- Quietly opens and closes to circulate fresh air throughout your home, giving you the feel of a cool breeze at the touch of a button
- Integrated rain sensor, the skylight will close automatically at the first sign of inclement weather.
- Seamlessly pairs with any VELUX shades for optimal light control — select shades can be pre-installed for free
- Pairs with VELUX ACTIVE: open and close your skylights from your phone or have it automatically adjust them to match your ideal indoor climate
- Flashing kit required for [No Leak Warranty](#)

## ACCESSORIES

- Factory pre-installed Room-Darkening or Light Filtering shades
- VELUX ACTIVE with NETATMO



## PRODUCT DETAILS

- **Laminated LoE3 Glass:** Laminated LoE3 Glass double-paned argon-gas-filled LoE3 glass that provides excellent energy performance for year round comfort. Plus, it includes the added safety of laminated glass, which building codes require for out-of-reach applications.
- [No Leak Warranty](#) - 10-year installation warranty, plus 20 years on glass, 10 years on product, and 5 years on shades and controls.
- Insect Screen and remote control
- 110v electrical wire, 20" in length

## OPTIONAL SKYLIGHT UPGRADES

- Impact Glass
- White Laminated Glass

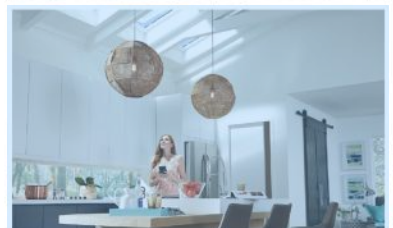

# Electric "Fresh Air" Deck-Mounted Skylight

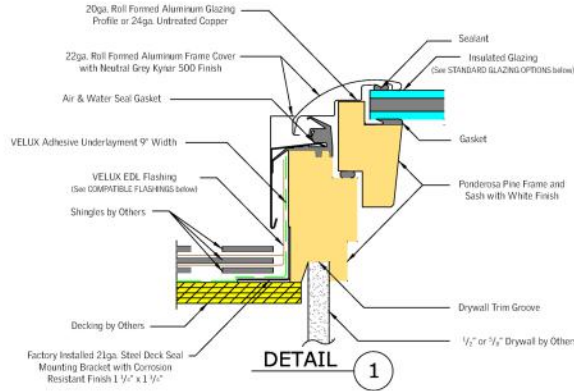
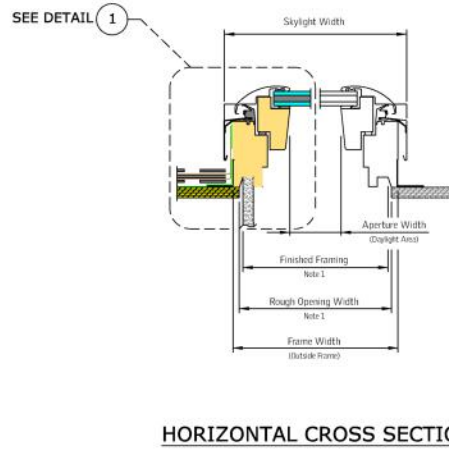
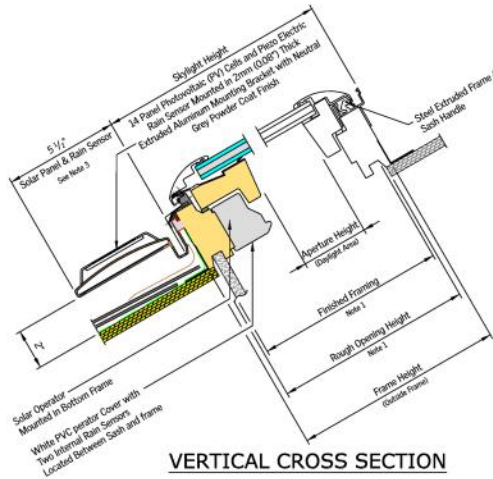

## COMPLIANCE AND CERTIFICATIONS

- DBPR Florida
- IAPMO
- NFRC, National Fenestration Rating Council
- Energy Star
- WDMA, Window & Door Manufacturing Association

		C01	C04	C06	C08	M02	M04	M06	M08	S01	S06
Rough Opening Width	(W-in.)	21	21	21	21	30 1/16	30 1/16	30 1/16	30 1/16	44 1/4	44 1/4
Rough Opening Height	(H-in.)	26 7/8	37 7/8	45 3/4	54 7/16	30	37 7/8	45 3/4	54 7/16	26 7/8	45 3/4
Daylight Area	(Sq. Feet)	2.27	3.50	4.38	5.34	4.11	5.48	6.86	8.36	5.57	10.73