

# Custom Prefabricated Sealant Pockets

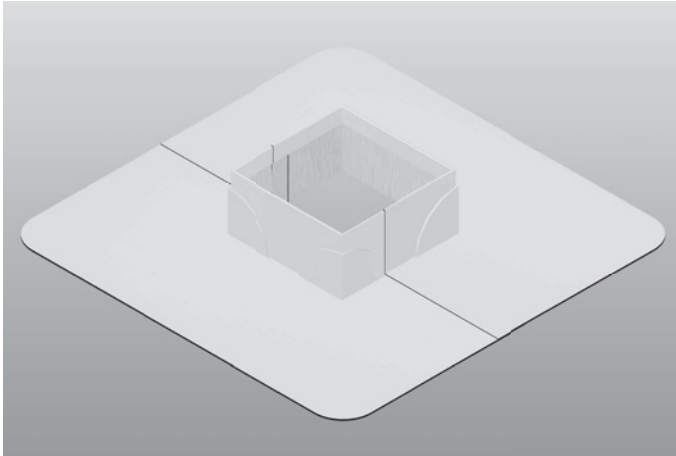

## Overview

Let Versico simplify your next VersiWeld® TPO installation with Custom Prefabricated Sealant Pockets. Versico's TPO Custom Prefabricated Sealant Pockets consist of a two-piece, prefabricated design that utilizes reinforced TPO detail membrane and coated metal to form a rigid, oversized sealant pocket. A weldable horizontal deck flange is fabricated from reinforced TPO detail membrane. The vertical wall consists of reinforced TPO membrane pre-welded to coated metal. White One-Part Sealant is used to fill the pocket to create a watertight seal.

Versico's TPO Custom Prefabricated Sealant Pockets are part of the Certified Fabricated Accessory (CFA) program. Certified Fabricated Accessories are the only factory-fabricated TPO accessories that meet the stringent quality tolerances required to be included in a Versico warranted roofing system.

## Features and Benefits

- Provides substantial labor savings compared to field-fabricating a sealant pocket from coated metal or other material
- Provides a reliable method for waterproofing large, odd-shaped penetrations
- Professional finished appearance

## Installation

1. Clean the inside surfaces of the TPO Custom Prefabricated Sealant Pocket, the underside of the deck flange and the deck membrane with Weathered Membrane Cleaner. (Use a Primer Pad with the cleaner if the membrane has been exposed for an extended period of time.)
2. Place the TPO Custom Prefabricated Sealant Pocket around the penetration(s), overlapping the two sections of the pocket.
3. Cut a piece of cardboard (approximately 4" x 4") and place between the overlapping area of the TPO Custom Prefabricated Sealant Pocket and the deck membrane. The cardboard prevents the pocket from fusing to the membrane when first welding the overlaps.
4. Using a hand-welder, weld the angle change in overlap area. Using the end of a seam probe assists in this process. The hand-welder temperature setting should be between 6 and 7.
5. Hand-weld the remainder of the horizontal overlap.
6. Position the TPO Custom Prefabricated Sealant Pocket so the vertical overlap is against the penetration. This will allow proper pressure to be applied to the overlap with the 2" silicone roller.
7. Weld both vertical overlaps, starting at the angle change and progressing to the top of the pocket.
8. Once the vertical overlaps are complete, re-position the pocket and tack-weld the flange to the membrane to hold it in place.
9. Weld the entire horizontal flange to the deck membrane.
10. Using a seam probe, check all splices for voids and cold-welds once the flashing has thoroughly cooled. Make any necessary repairs.
11. Apply a thin coat of TPO Primer to the TPO membrane and penetration(s) surfaces only using a small paintbrush. Do not apply TPO Primer to the galvanized metal surface utilized on the inside of the Sealant Pocket.
12. Fill the pocket with White One-Part Sealant. Use an adequate amount of sealant to ensure that contact is made with the top rim of the pocket.

REVIEW CURRENT VERSICO SPECIFICATIONS AND DETAILS FOR SPECIFIC INSTALLATION REQUIREMENTS.



# Custom Prefabricated Sealant Pockets

## Precautions

- Temperature of penetration shall not exceed 160°F (71°C).
- Apply TPO Primer to the TPO membrane and penetration(s) surfaces only. Do not apply TPO Primer to the galvanized metal surface utilized on the inside of the sealant pocket.
- Versico's White One-Part Sealant must completely fill sealant pocket.
- The walls of the sealant pocket must be a minimum of 1" from any penetration.
- UV-filtering sunglasses are strongly recommended when working on TPO Roofing Systems.
- Store sealant pockets in a cool, shaded area and cover with light-colored, breathable, waterproof tarpaulins. Custom Prefabricated Sealant Pockets or membrane that have been exposed to the weather must be prepared with Weathered Membrane Cleaner prior to hot-air welding. (Primer pads must be used if the membrane has been exposed for an extended period of time.)

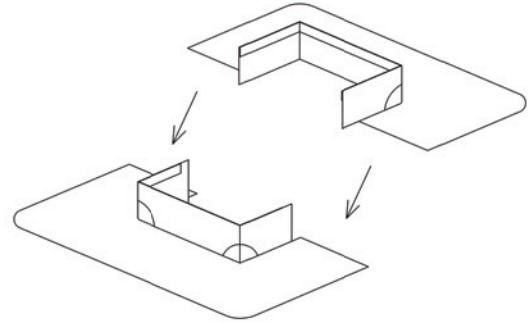

Pocket Size	Dimensions		
	A	B	C
12" (30.48 cm)	12" (15.24 cm)	12" (30.48 cm)	24" (60.96 cm)

## LEED® Information

Pre-consumer Recycled Content	0%
Post-consumer Recycled Content	0%
Manufacturing Locations	Piedmont, SC Eugene, OR
Solar Reflectance Index (SRI)	N/A