

# ACCESSORIES AND DETAILS

## K SERIES OPEN WEB STEEL JOISTS

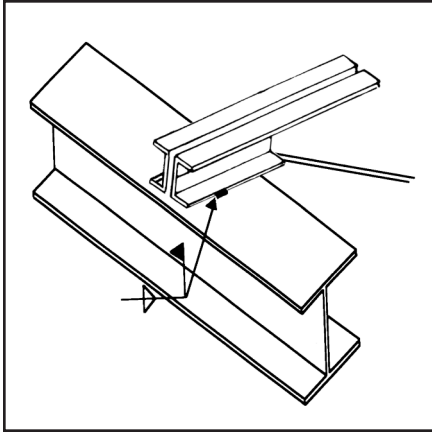

ANCHORAGE TO STEEL  
SEE SJI SPECIFICATION 5.3 (b) AND 5.6

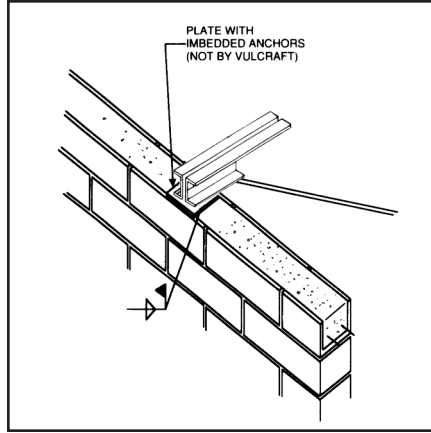

ANCHORAGE TO MASONRY  
SEE SJI SPECIFICATION 5.3 (a) AND 5.6

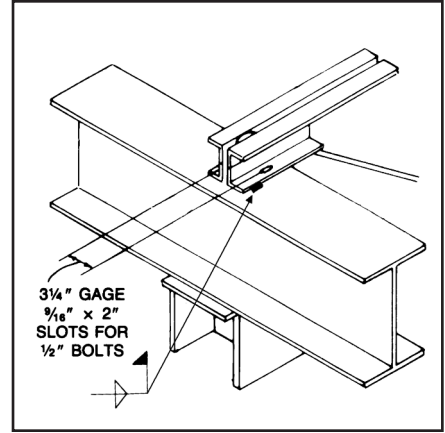

BOLTED CONNECTION\*  
TYPICALLY REQUIRED AT COLUMNS

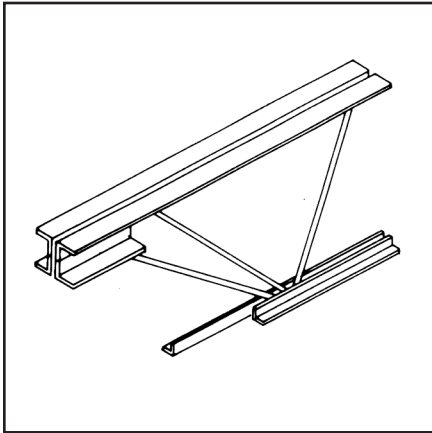

CEILING EXTENSION

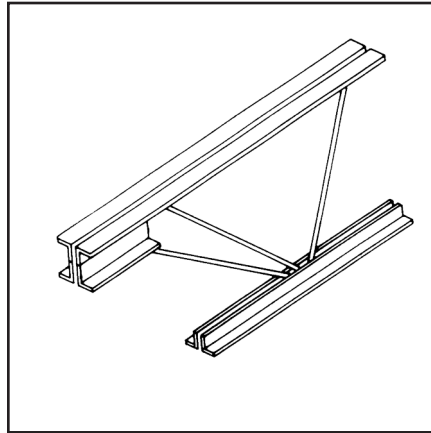

BOTTOM CHORD STRUT

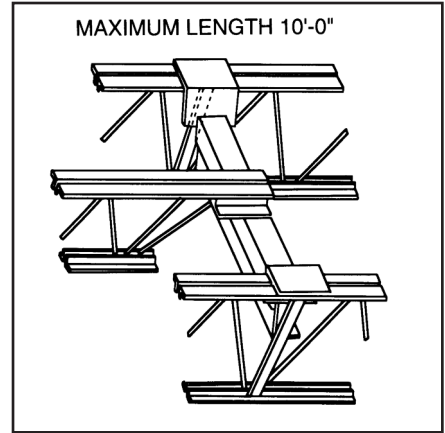

HEADERS

Note: If header does not bear at a Joist Panel Point add extra web in field as shown.  
EW or Panel Point by Vulcraft

### MAXIMUM DUCT OPENING SIZES (K SERIES)\*

JOIST DEPTH	ROUND	SQUARE	RECTANGLE
8 inches	5 inches	4x4 inches	3x8 inches
10 inches	6 inches	5x5 inches	3x8 inches
12 inches	7 inches	6x6 inches	4x9 inches
14 inches	8 inches	6x6 inches	5x9 inches
16 inches	9 inches	7 1/2x 7 1/2 inches	6X10 inches
18 inches	11 inches	8x8 inches	7x11 inches
20 inches	11 inches	9x9 inches	7x12 inches
22 inches	12 inches	9 1/2 x9 1/2 inches	8x12 inches
24 inches	13 inches	10x10 inches	8x13 inches
26 inches	15 1/2 inches	12x12 inches	9x18 inches
28 inches	16 inches	13x13 inches	9x18 inches
30 inches	17 inches	14x14 inches	10x18 inches

**\*FOR LH SERIES CONSULT WITH VULCRAFT**

SEE SJI SPECIFICATION - SECTION 6.  
FOR HANDLING AND ERECTION OF K-  
SERIES OPEN WEB STEEL JOISTS AND  
SJI TECHNICAL DIGEST NO. 9.

SPECIFYING PROFESSIONAL MUST INDICATE ON STRUCTURAL DRAWINGS SIZE AND LOCATION OF ANY DUCT THAT IS TO PASS THRU JOIST.

# ACCESSORIES AND DETAILS

## K SERIES OPEN WEB STEEL JOISTS

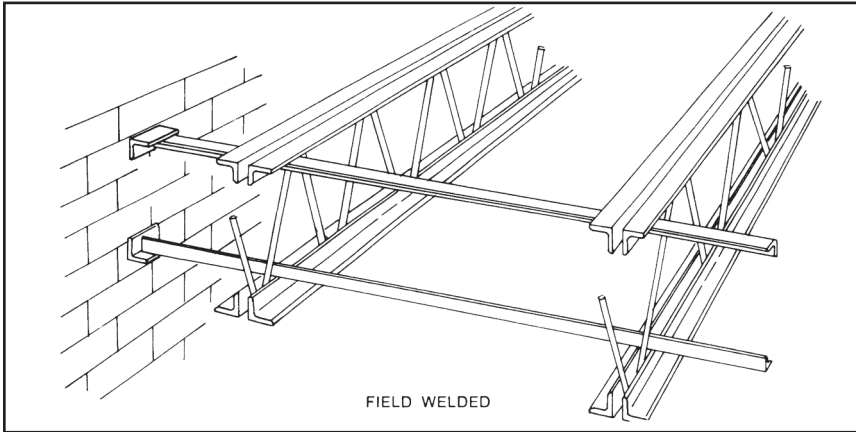

**HORIZONTAL BRIDGING**  
SEE SJI SPECIFICATION 5.5 AND 6.

NOTE: DO NOT WELD BRIDGING TO JOIST WEB MEMBERS.  
DO NOT HANG ANY MECHANICAL, ELECTRICAL, ETC. FROM BRIDGING.

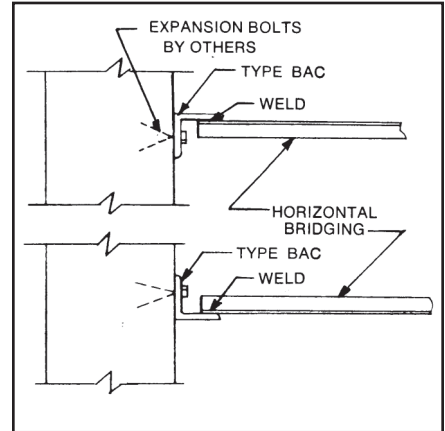

**BRIDGING ANCHORS**  
SEE SJI SPECIFICATION 5.5 AND 6.

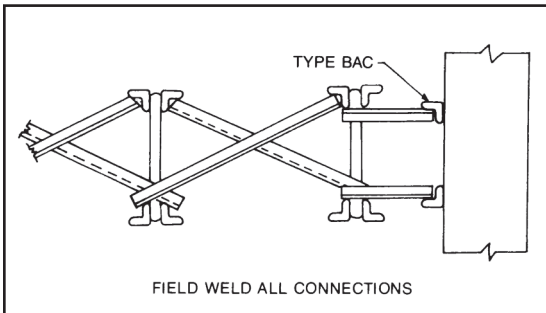

**WELDED CROSS BRIDGING**  
SEE SJI SPECIFICATION 5.5 AND 6.  
HORIZONTAL BRIDGING SHALL BE USED IN SPACE ADJACENT TO THE WALL TO ALLOW FOR PROPER DEFLECTION OF THE JOIST NEAREST THE WALL.

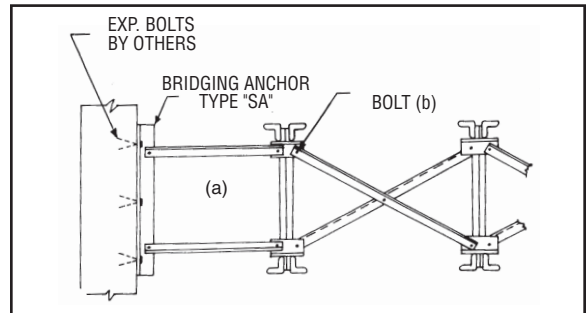

**BOLTED CROSS BRIDGING**  
SEE SJI SPECIFICATION 5.5 AND 6.

(a) Horizontal Bridging units shall be used in the space adjacent to the wall to allow for proper deflection of the joist nearest the wall.

(b) For required bolt size refer to bridging table on page 136.  
NOTE: Clip configuration may vary from that shown.

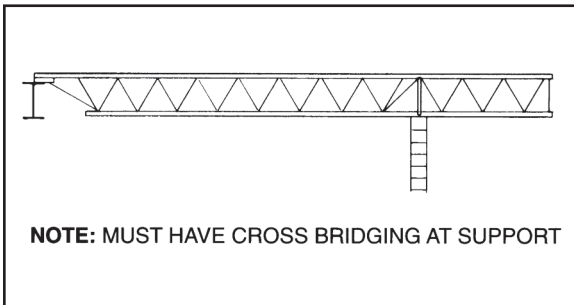

**NOTE: MUST HAVE CROSS BRIDGING AT SUPPORT**

**FULL DEPTH CANTILEVER END**  
SEE SJI SPECIFICATION 5.4 (d) AND 5.5 FOR BRIDGING REQUIREMENTS.

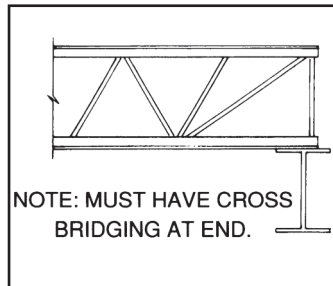

**NOTE: MUST HAVE CROSS BRIDGING AT END.**

**SQUARE END**  
SEE SJI SPECIFICATION 5.4 (d) AND 5.5 FOR BRIDGING REQUIREMENTS.

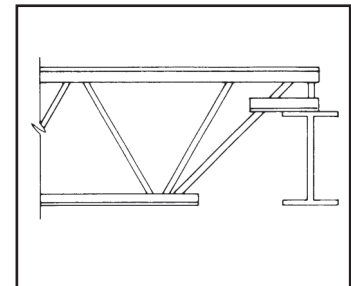

**DEEP BEARINGS**  
CONFIGURATION MAY VARY