

PRODUCT SUBMITTAL

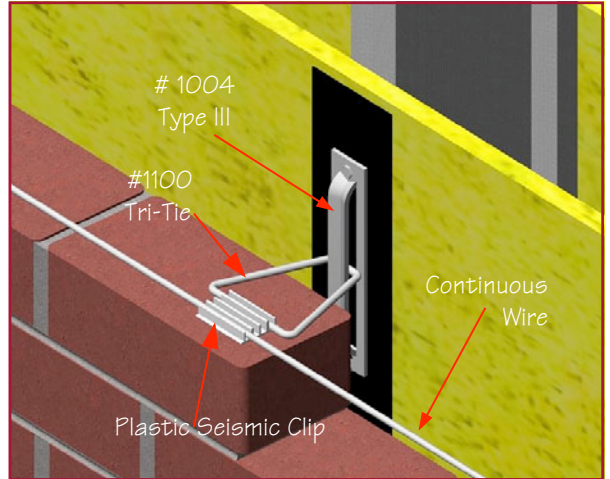

Plastic Seismic Clip #3690

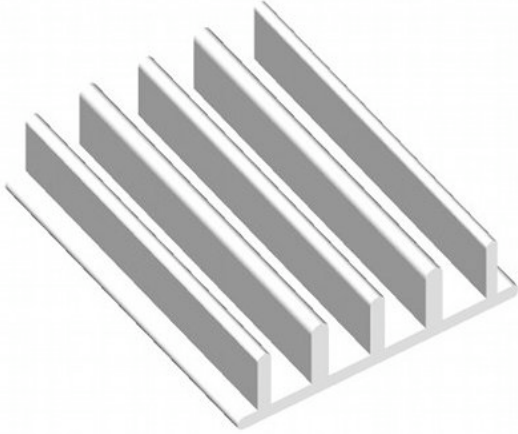

Type III Seismic

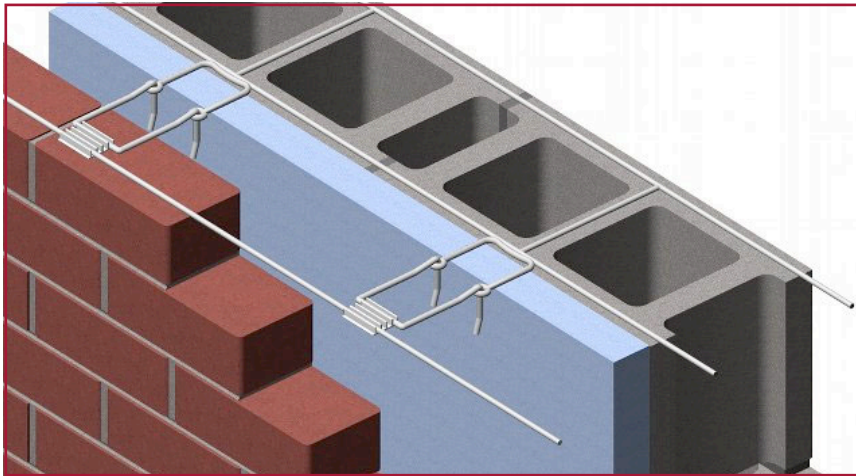

Level Eye Ladder Seismic

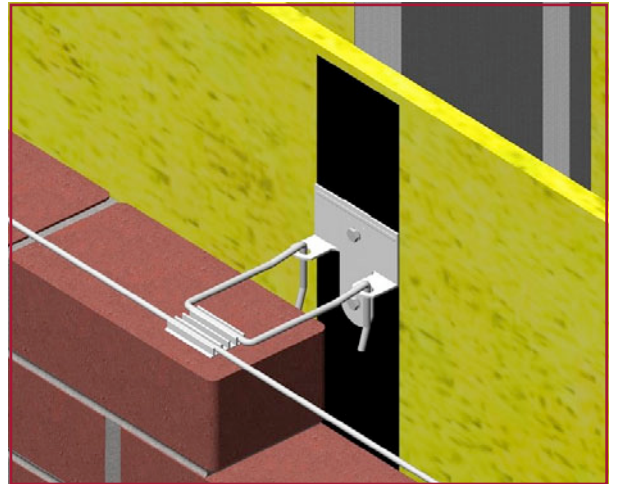

RJ-711 Seismic

Plastic Seismic Clip:
ASTM D1784

DIMENSIONS:
5/16" x 1-1/8" x 1-3/4"

0% Post-Consumer 0% Post Industrial / Pre - Consumer

WIRE-BOND®'s Plastic Seismic Clip accepts both 9 ga and 3/16" dia pencil rod and is used with ladder or truss style adjustable joint reinforcement to reinforce the outer wythe of a wall. Used also with triangles to reinforce brick with pencil rod.



Straight & Cut Seismic Wire Gauge: 9 gauge 3/16"Ø **Finish:** Hot Dip Galvanized Stainless Steel

ASTM A82 / A82M - (Cold drawn steel wire) Tensile Strength - 80,000 psi Yield Point - 70,000 psi
ASTM A951 / A951M-06 - (Standard Specification for Steel Wire for Masonry Joint Reinforcement)
ACI / ASCE 530 - (Building code requirements for masonry structures Hot Dip Galvanized after fabrication / Zinc Coating)
ASTM A153 / A153M-B2 (1.50 oz per sq ft)
 Stainless Steel **ASTM 580 / ASTM 580M Type 304** (Type 316 available on special order)

K J Y Recycled Content:
 Mill Galvanized & Hot Dipped,
 82.8% Post-Consumer
 17% Post Industrial / Pre-Consumer,

 Stainless Steel,
 60% Post Consumer
 V O C Content - 0%

Corporate Office: 400 Rountree Rd Charlotte, NC 28217
 TEL: (800) 849-6722 FAX: (704) 525-3761

Mailing Address: P.O. Box 240988 Charlotte, NC 28224



www.wirebond.com

Memphis Plant: 2365 Harbor Ave. Memphis, TN 38113
 TEL: (800) 441-8359 FAX: (901) 775-9449

Mailing Address: P.O. Box 13124 Memphis, TN 38113