

# PRODUCT SUBMITTAL

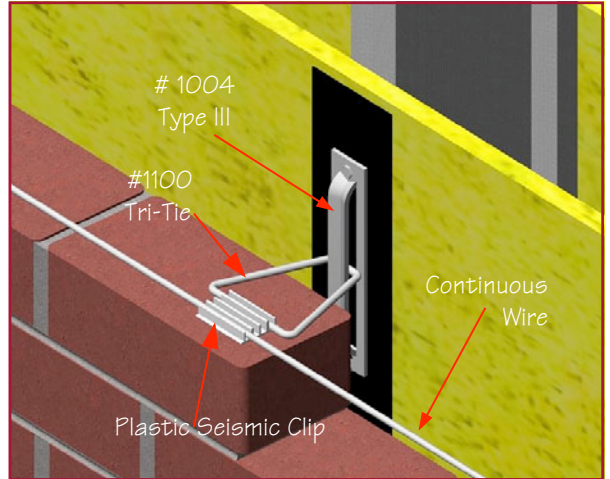

## Plastic Seismic Clip #3690

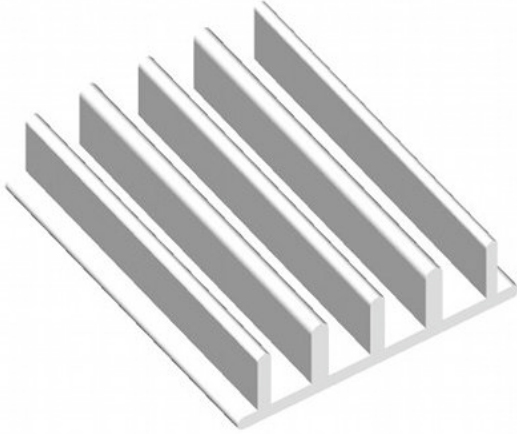

Type III Seismic

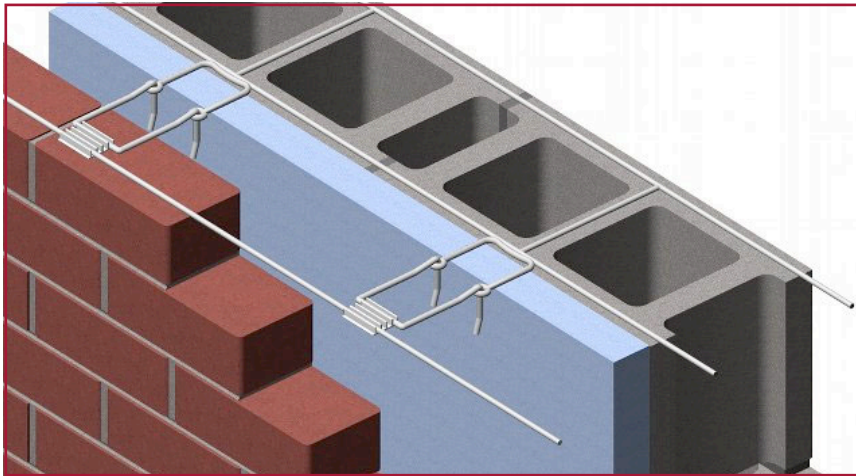

Level Eye Ladder Seismic

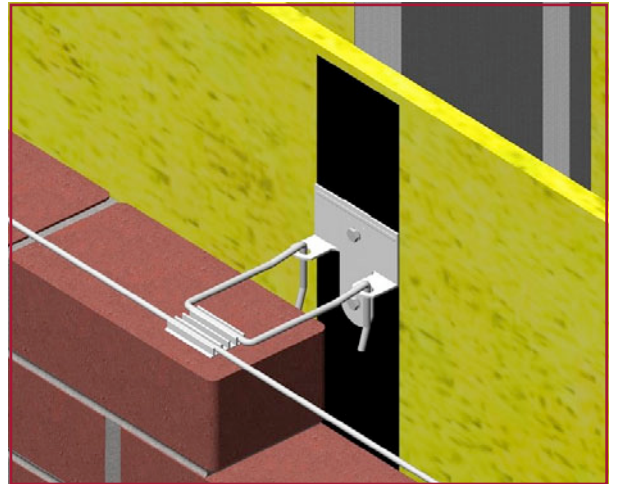

RJ-711 Seismic

**Plastic Seismic Clip:**  
**ASTM D1784**

**DIMENSIONS:**  
5/16" x 1-1/8" x 1-3/4"

0% Post-Consumer 0% Post Industrial / Pre - Consumer

WIRE-BOND®'s Plastic Seismic Clip accepts both 9 ga and 3/16" dia pencil rod and is used with ladder or truss style adjustable joint reinforcement to reinforce the outer wythe of a wall. Used also with triangles to reinforce brick with pencil rod.



**Straight & Cut Seismic Wire**      **Gauge:** 9 gauge      3/16"Ø      **Finish:** Hot Dip Galvanized      Stainless Steel

**ASTM A82 / A82M** - (Cold drawn steel wire) Tensile Strength - 80,000 psi Yield Point - 70,000 psi  
**ASTM A951 / A951M-06** - (Standard Specification for Steel Wire for Masonry Joint Reinforcement)  
**ACI / ASCE 530** - (Building code requirements for masonry structures Hot Dip Galvanized after fabrication / Zinc Coating)  
**ASTM A153 / A153M-B2 (1.50 oz per sq ft)**  
 Stainless Steel **ASTM 580 / ASTM 580M Type 304** (Type 316 available on special order)

**K J Y Recycled Content:**  
 Mill Galvanized & Hot Dipped,  
 82.8% Post-Consumer  
 17% Post Industrial / Pre-Consumer,  
  
 Stainless Steel,  
 60% Post Consumer  
 V O C Content - 0%

**Corporate Office:** 400 Rountree Rd Charlotte, NC 28217  
 TEL: (800) 849-6722 FAX: (704) 525-3761

**Mailing Address:** P.O. Box 240988 Charlotte, NC 28224



[www.wirebond.com](http://www.wirebond.com)

**Memphis Plant:** 2365 Harbor Ave. Memphis, TN 38113  
 TEL: (800) 441-8359 FAX: (901) 775-9449

**Mailing Address:** P.O. Box 13124 Memphis, TN 38113