

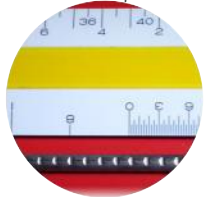

PRODUCT SUBMITTAL

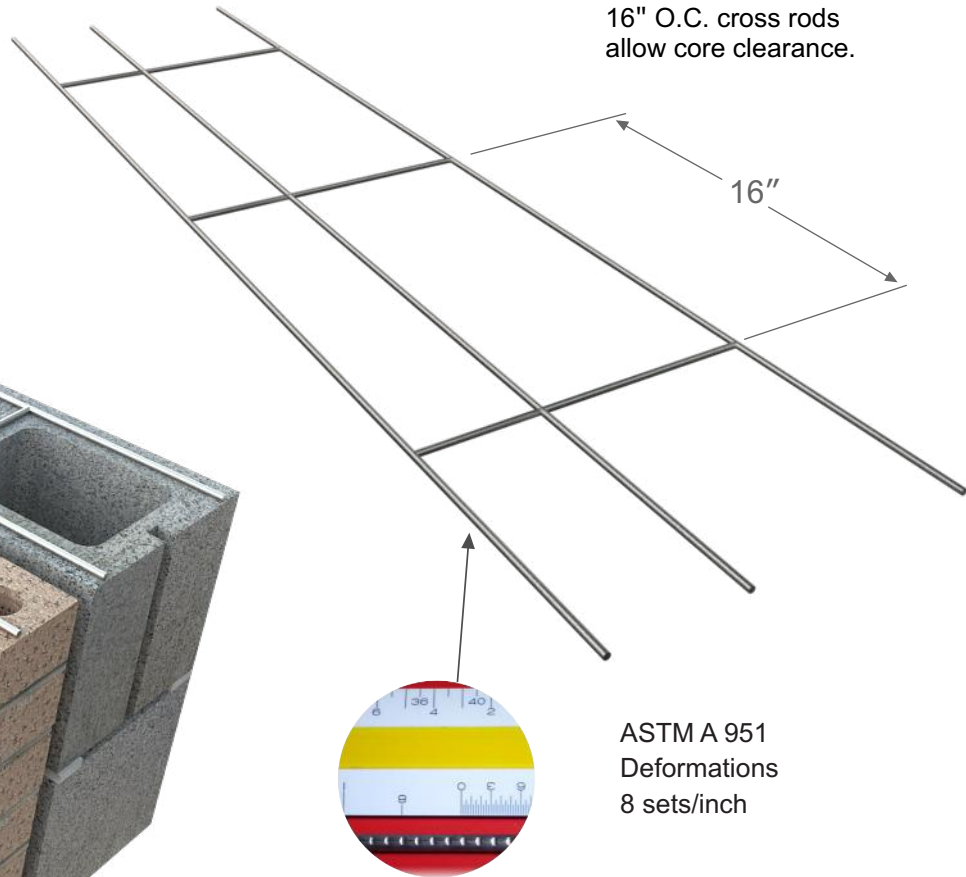

Series 200 Ladder Mesh (3 Wire System)

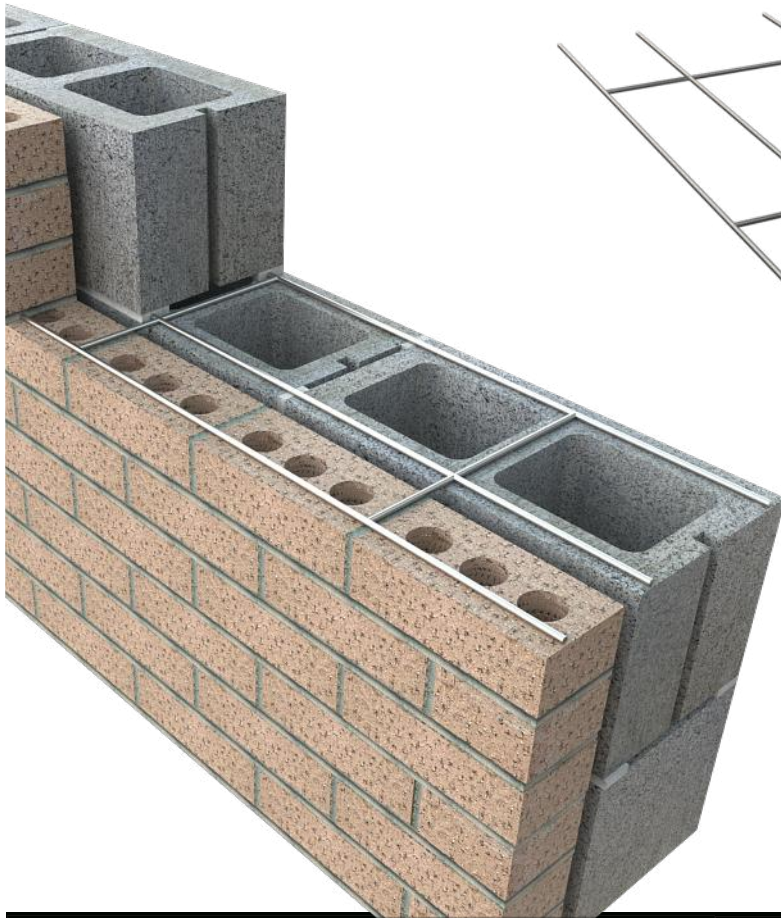

ASTM A 951
Deformations
8 sets/inch

MATERIAL CONFORMANCE	SIZES / FINISHES																															
<p>Wire (Carbon Steel): Prefabricated from cold-drawn steel wire conforming to ASTM A1064/A1064M, ASTM A82/ A82M</p> <p>Tensile Strength - 80,000 p.s.i. Yield Point - 70,000 p.s.i. minimum</p> <p>ASTM A951/A951M (Standard Specification for Steel Wire for Masonry Joint Reinforcement)</p> <p>ACI / ASCE 530 (Building Code Requirements for Masonry Structures)</p> <p>Mill Galvanized coating: ASTM A641/A641M (0.1 oz/ft)</p> <p>Hot-Dip Galvanized after fabrication: ASTM A153/A153M-B2 (1.5 oz/ft)</p> <p>Wire (Stainless Steel): ASTM A580/ASTM 580M - AISI Type 304 (Type 316 available on special orders)</p>	<p>WIRE SIZE:</p> <table border="0"> <tr> <td>Standard</td> <td>9 Gauge (.148 in)</td> <td>CROSS RODS:</td> <td>9 Gauge</td> </tr> <tr> <td>Heavy Duty</td> <td>3/16 (.187 in)</td> <td></td> <td>9 Gauge</td> </tr> <tr> <td>Extra Heavy Duty</td> <td>3/16 (.187 in)</td> <td></td> <td>3/16</td> </tr> </table> <p>10' length standard, custom length available special order)</p> <p>CMU SIZE:</p> <table border="0"> <tr> <td>4"</td> <td>6"</td> <td>8"</td> <td>10"</td> <td>12"</td> <td>14"</td> <td>16"</td> </tr> </table> <p>FINISHES:</p> <table border="0"> <tr> <td>Mill Galvanized</td> <td>Stainless Steel:</td> </tr> <tr> <td></td> <td>Type 304 Type 316</td> </tr> <tr> <td>Hot Dip Galvanized</td> <td></td> </tr> </table> <p>Please state overall wall size when ordering</p>							Standard	9 Gauge (.148 in)	CROSS RODS:	9 Gauge	Heavy Duty	3/16 (.187 in)		9 Gauge	Extra Heavy Duty	3/16 (.187 in)		3/16	4"	6"	8"	10"	12"	14"	16"	Mill Galvanized	Stainless Steel:		Type 304 Type 316	Hot Dip Galvanized	
Standard	9 Gauge (.148 in)	CROSS RODS:	9 Gauge																													
Heavy Duty	3/16 (.187 in)		9 Gauge																													
Extra Heavy Duty	3/16 (.187 in)		3/16																													
4"	6"	8"	10"	12"	14"	16"																										
Mill Galvanized	Stainless Steel:																															
	Type 304 Type 316																															
Hot Dip Galvanized																																
<p>Recycled Content: Mill Galvanized & Fot Dipped, 82.8% Post-Consumer 17% Post Industrial / Pre Consumer</p> <p>Stainless Steel 97% Pre-Consumer V O C Content - 0%</p>																																

Corporate Office: 400 Rountree Rd Charlotte, NC 28217
TEL: (800) 849-6722 FAX: (704) 525-3761



Memphis Plant: 2365 Harbor Ave. Memphis, TN 38113
TEL: (800) 441-8359 FAX: (901) 775-9449

Mailing Address: P.O. Box 240988 Charlotte, NC 28224

www.wirebond.com

Mailing Address: P.O. Box 13124 Memphis, TN 38113