

PRODUCT SUBMITTAL

Series 900 Truss Level-Eye (Hook & Eye)

WIRE-BOND

Flush welded to face of longitudinal wire to meet TCM 402 Code

Height of the reinforcing will not exceed half the dimension of the joint (3/8" joint = 3/16" max reinforcement).

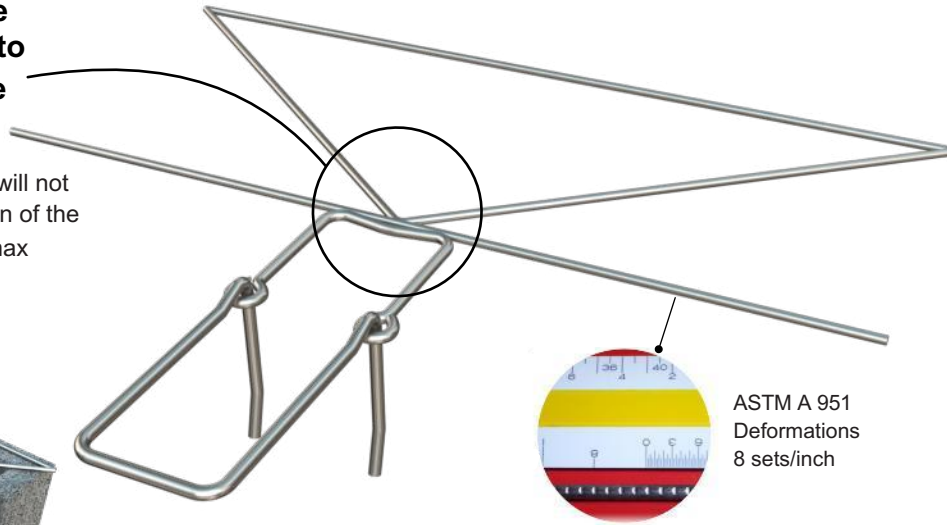
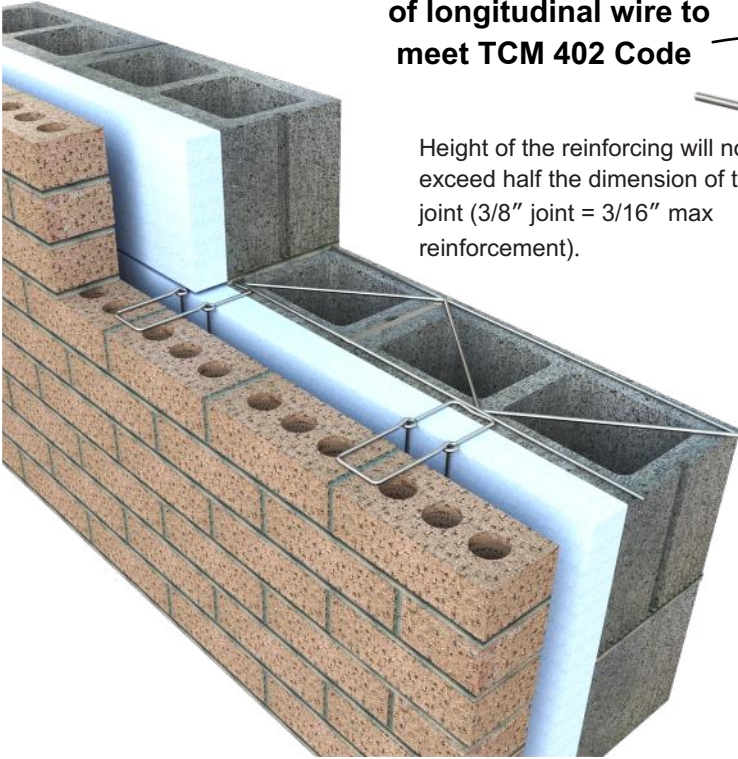

ASTM A 951
Deformations
8 sets/inch

- Double eye is butt welded to side rod 16" O.C.
- Height of double eye will not exceed 3/16" in bed joint.
- Easier to maintain 3/8" mortar joint.

STRUCTURAL PERFORMANCE CHARACTERISTICS

Capable of withstanding 100 lbs load in tension and compression without deforming or developing play in excess of .05 inch.

MATERIAL CONFORMANCE	SIZES / FINISHES						
Wire (Carbon Steel): Prefabricated from cold-drawn steel wire conforming to ASTM A1064/A1064M, ASTM A82/ A82M	WIRE SIZE:			SIDE RODS:		CROSS RODS:	
Tensile Strength - 80,000 p.s.i. Yield Point - 70,000 p.s.i. minimum	Standard	9 Gauge (.148 in)	9 Gauge	9 Gauge	9 Gauge	9 Gauge	9 Gauge
ASTM A951/A951M (Standard Specification for Steel Wire for Masonry Joint Reinforcement)	Heavy Duty	3/16 (.187 in)	3/16	3/16	3/16	3/16	3/16
ACI / ASCE 530 (Building Code Requirements for Masonry Structures)	Extra Heavy Duty	3/16 (.187 in)	3/16	3/16	3/16	3/16	3/16
Mill Galvanized coating: ASTM A641/A641M (0.1 oz/ft)	CMU SIZE:						
Hot-Dip Galvanized after fabrication: ASTM A153/A153M-B2 (1.5 oz/ft)	4"	6"	8"	10"	12"	14"	16"
Wire (Stainless Steel): ASTM A580/ASTM 580M - AISI Type 304 (Type 316 available on special orders)	Insulation:						
	0"	1"	1-1/2"	2"	2-1/2"	3"	
		3-1/2"	4"				
Recycled Content: Mill Galvanized & Hot Dipped, 82.8% Post-Consumer 17% Post Industrial / Pre Consumer	PINTLE: 3/16" dia. standard						
Stainless Steel 97% Pre-Consumer V O C Content - 0%	Length:		3-1/4"	4-1/4"	5-1/4"	Other	
	FINISHES:		Hot Dip Galvanized		Stainless Steel		

Corporate Office: 400 Rountree Rd Charlotte, NC 28217
TEL: (800) 849-6722 FAX: (704) 525-3761

Mailing Address: P.O. Box 240988 Charlotte, NC 28224



www.wirebond.com

Memphis Plant: 2365 Harbor Ave. Memphis, TN 38113
TEL: (800) 441-8359 FAX: (901) 775-9449

Mailing Address: P.O. Box 13124 Memphis, TN 38113