

# PRODUCT SUBMITTAL

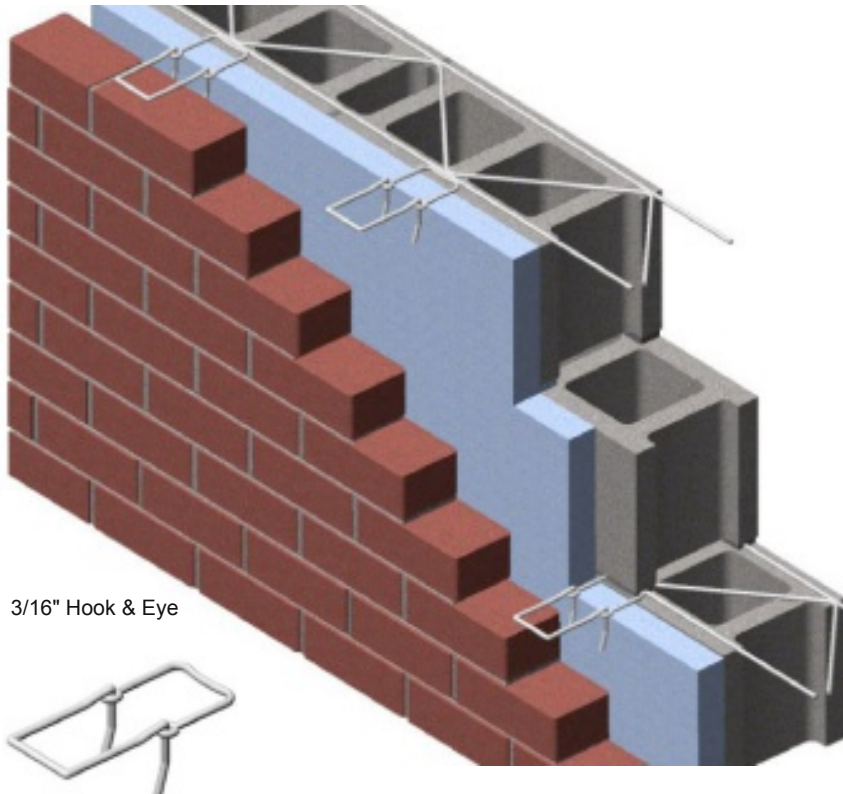

## Series 900 Truss Level-Eye (Hook & Eye) with HT Hook



3/16" Hook & Eye



### NEW! HT HOOK



High Tensile Hook has 2 to 2-1/2 times the strength of a normal hook with no change in design or diameter.

### Simple yet stronger!

Developed to meet code requirements for  $\phi^{\wedge} \Delta$  wide cavities (insulation + air-space) and higher wind loads.

Cross rods welded 16" O.C.

- Double eye is butt welded to side rod 16" O.C.
- Height of double eye will not exceed 3/16" in bed joint.
- Easier to maintain 3/8" mortar joint.

**HT HOOK:** Fabricated from Music Spring Wire meeting **ASTM A228** with a tensile strength of **250,000 psi**.

Test Results available upon request.

MATERIAL CONFORMANCE		SIZES / FINISHES					
<p><b>ASTM A82 / A82M</b> - (Cold drawn steel wire) Tensile Strength - 80,000 psi Yield Point - 70,000 psi</p> <p><b>ASTM A951 / A951M-06</b> - (Standard Specification for Steel Wire for Masonry Joint Reinforcement)</p> <p><b>ACI / ASCE 530</b> - (Building code requirements for masonry structures Mill Galvanized / Zinc Coating: <b>ASTM A641 / A641M (0.10 Oz per sq ft)</b> Hot Dip Galvanized after fabrication / Zinc Coating: <b>ASTM A153 / A153M-B2 (1.50 oz per sq ft)</b></p> <p>Stainless Steel <b>ASTM 580 / 580M Type 304</b> (Type 316 available on special orders)</p>							
<p><b>Recycled Content:</b> Mill Galvanized &amp; Hot Dipped, 82.8% Post-Consumer 17% Post Industrial / Pre-Consumer,</p> <p>Stainless Steel, 97% Pre-Consumer V O C Content - 0%</p>		<p><b>WIRE SIZE:</b></p> <p>Standard 9 Gauge (.148 in) Heavy Duty 3/16" (.187 in) Extra Heavy Duty 3/16" (.187 in)</p>		<p><b>Side Rods</b></p>		<p><b>Cross Rods</b></p>	
		<p><b>BLOCK SIZE:</b></p> <p>4" 6" 8" 10" 12" 14" 16"</p>		<p><b>HT PINTLE:</b> 3/16" Standard</p> <p><b>Length:</b> 3-1/4" 4-1/4" 5-1/4" Other</p>		<p><b>INSULATION:</b></p> <p>0" (1-1/4" eye) 1" (2-1/4" eye) 1-1/2" (2-3/4" eye) 2" (3-1/4" eye) 2-1/2" (3-3/4" eye) 3" (4-1/4" eye) 3-1/2" (4-3/4" eye) 4" (5-1/4" eye) 4-1/2" (5-3/4" eye)</p>	
		<p><b>FINISHES:</b></p> <p>Mill Galvanized Hot Dip Galvanized Stainless Steel</p>					

Corporate Office: 400 Rountree Rd Charlotte, NC 28217  
TEL: (800) 849-6722 FAX: (704) 525-3761  
Mailing Address: P.O. Box 240988 Charlotte, NC 28224



www.wirebond.com

Memphis Plant: 2365 Harbor Ave. Memphis, TN 38113  
TEL: (800) 441-8359 FAX: (901) 775-9449  
Mailing Address: P.O. Box 13124 Memphis, TN 38113