



PLYWOOD SHEATHING JOINT DETAIL INSTALLATION GUIDELINES

This document has been created as an addendum to our **AIR-SHIELD™** technical data sheets to provide information regarding the recommended treatment of joints in plywood sheathing when using the **AIR-SHIELD** fluid-applied membranes. These include **AIR-SHIELD LM**, **AIR-SHIELD LM (ALL SEASON)**, **AIR-SHIELD LMP**, **AIR-SHIELD TMP**, and **AIR-SHIELD LSR**.

Following is the typical installation instructions recommended by W. R. MEADOWS. However, it is important to review each application as there may be situations that may require this procedure to be modified based on the project requirements. If this situation arises, please contact W. R. MEADOWS Technical Service.

1. Fasten boards according to instructions according to board manufacturer.
2. Prime either side of the joint with **MEL-PRIME™** 3" (76.2 mm) either side of center.
3. Apply a 4" (25.4 mm) strip of **AIR-SHIELD** centered over the joint and roll firmly into place. For joints wider than 1/4" (6.4 mm), fill with **BEM** from W. R. MEADOWS prior to application of **AIR-SHIELD**.

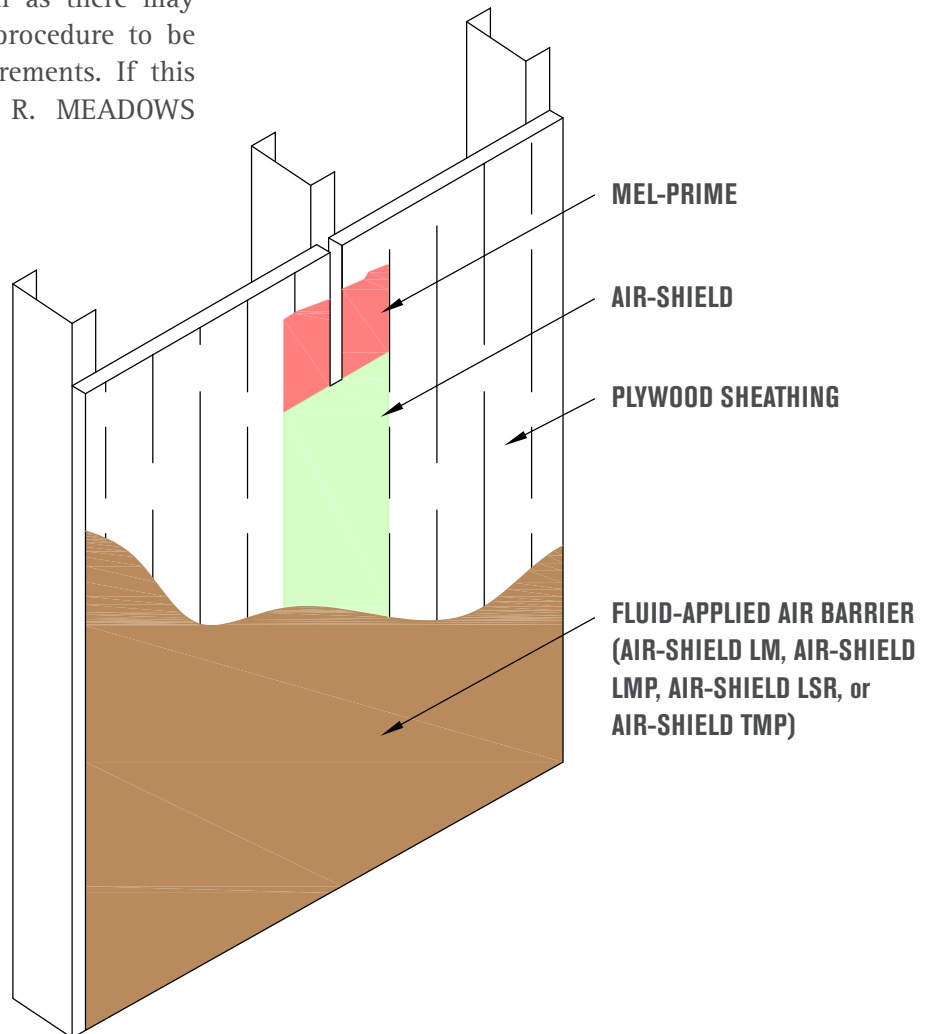

W. R. MEADOWS, INC. | P.O. Box 338 | HAMPSHIRE, IL 60140-0338
Phone: 847/214-2100 | Fax: 847/683-4544 | www.wrmeadows.com